

# HURON ELEMENTARY SCHOOL

## Master Schedule

The Master Schedule for each school/campus provides clarity of assignment for school administration and facility operations leadership.



# Individual Schedule

## HURON ELEMENTARY SCHOOL



Schedule 2		Hrs/Day	
1:30 PM	9:30 PM	Level 2.75	8
		Suggested Min.	Hrs.
1:30 PM	95	Shift preparation	5 0.1
1:35 PM	132	Garbage Run	10 0.3
1:45 PM	133	Garbage Run	10 0.4
1:55 PM	79	C108	20 0.8
2:15 PM	116	Support/Projects	30 1.3
2:45 PM	117	Support/Projects	10 1.4
2:55 PM	4	Off RRs	4 1.5
2:59 PM	10	Off RRs	4 1.6
3:03 PM	13	Off RRs	4 1.6
3:07 PM	42	B Wing RR	21 2.0
3:28 PM	98	Break	15 2.2
3:43 PM	43	B Wing RR	8 2.4
3:52 PM	44	B Wing RR	8 2.5
4:00 PM	45	B Wing RR	4 2.6
4:04 PM	32	Storeroom	0 2.6
4:04 PM	33	A Wing RR	4 2.6
4:08 PM	34	A Wing RR	8 2.8
4:17 PM	35	A Wing RR	8 2.9
4:25 PM	36	A Wing RR	21 3.3
4:46 PM	39	B107	2 3.3
4:48 PM	40	B108	3 3.4
4:51 PM	37	A121	16 3.6
5:07 PM	38	Library	18 3.9
5:25 PM	46	Storeroom	0 3.9
5:25 PM	47	Storeroom	0 3.9
5:25 PM	50	B117	13 4.1
5:38 PM	97	Lunch	30 4.6
6:08 PM	49	B116	13 4.8
6:20 PM	51	B118	9 5.0
6:29 PM	52	Storeroom	0 5.0
6:29 PM	53	B120	2 5.0
6:31 PM	54	B121	13 5.2
6:44 PM	55	B122	13 5.4
6:56 PM	56	B123	13 5.7
7:09 PM	57	B124	13 5.9
7:21 PM	58	B125	13 6.1
7:34 PM	60	B126	13 6.3
7:47 PM	98	Break	15 6.5
8:02 PM	61	B127	13 6.7
8:14 PM	62	B128	12 7.0
8:27 PM	65	B104	13 7.2
8:40 PM	66	Storeroom	0 7.2
8:40 PM	59	B Wing	5 7.2
8:44 PM	63	Corridor	1 7.3
8:45 PM	64	Corridor	2 7.3
8:47 PM	41	Corridor	8 7.4
8:56 PM	1	Corridor	1 7.5
8:57 PM	12	Corridor	2 7.5
8:59 PM	112	Support/Projects	10 7.7
9:09 PM	118	Support/Projects	10 7.8
9:19 PM	115	Lock Buildings	10 8.0
9:29 PM	99	Clean up	5 8.1

**Individual Schedule:**  
Each custodian has colored area and detailed listing of suggested minutes for each room and sequence of cleaning.

# Master Schedule

The Master Schedule for each school/campus provides clarity of assignment for school administration and facility operations leadership.

Schedule 1	6:15 AM	8.5
Schedule 2	12:00 PM	8.5
Schedule 3	4:45 PM	3.75

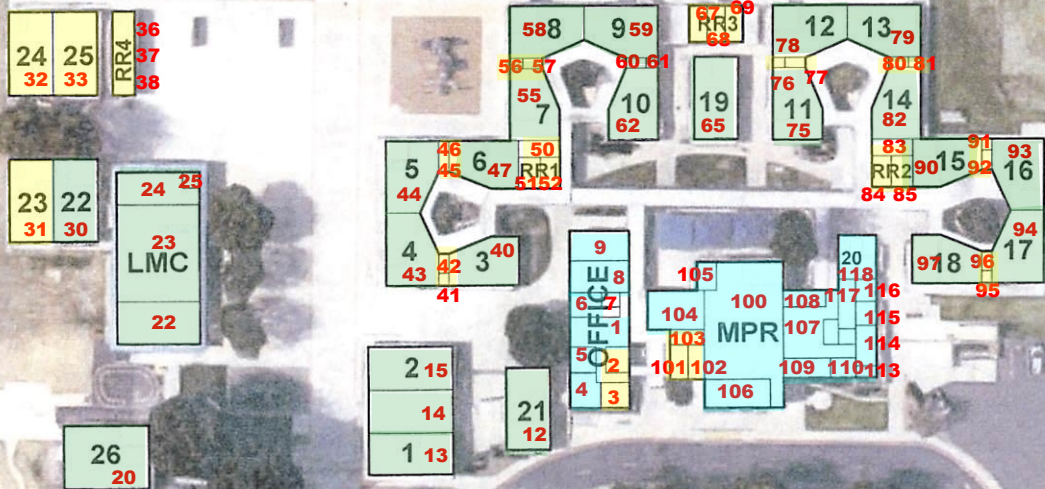

# Individual Schedule

Schedules are developed by statistical data, include breaks, lunch, and duties other than cleaning. They have suggested minutes per area, sequence of duties and reference to the colored site plan.

Schedule 1	6:15 AM	8.5
Schedule 2	12:00 PM	8.5
Schedule 3	4:45 PM	3.75

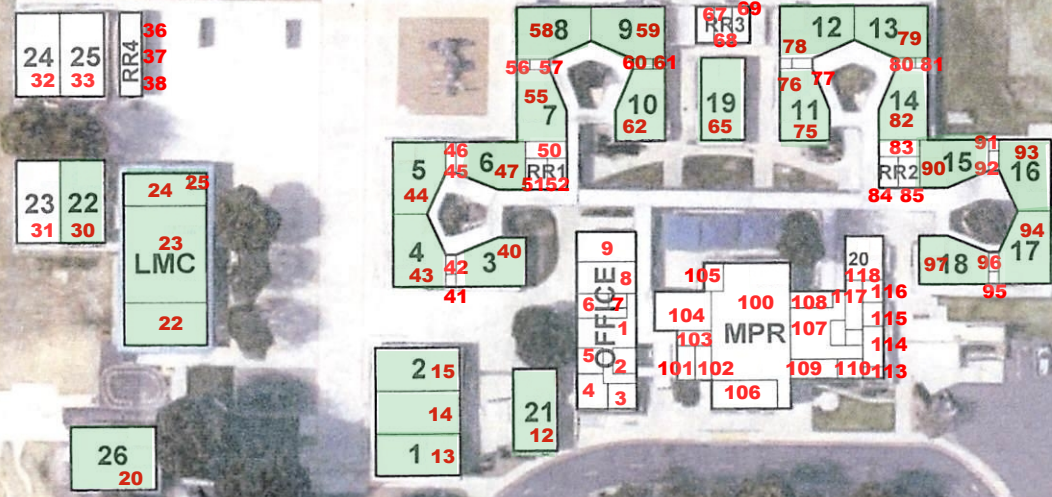

Custodian		Hrs/Day	2
12:00 PM	8:30 PM	Level 3	8.5
Suggested Min.		Hrs.	
12:00 PM	235	Shift preparation	5 0.1
12:05 PM	210	Support/Projects	30 0.6
12:35 PM	211	Support/Projects	10 0.8
12:45 PM	219	Support/Projects	10 0.9
12:55 PM	12 21		14 1.2
1:09 PM	13 1		14 1.4
1:23 PM	14	Classroom	14 1.6
1:37 PM	15 2		14 1.9
1:51 PM	236	Break	15 2.1
2:06 PM	20 26		14 2.3
2:20 PM	22	LMC	10 2.5
2:30 PM	23	LMC	23 2.9
2:53 PM	24	LMC	7 3.0
3:00 PM	30 22		14 3.2
3:14 PM	40 3		14 3.5
3:28 PM	43 4		14 3.7
3:42 PM	44 5		14 3.9
3:56 PM	237	Lunch	30 4.4
4:26 PM	47 6		14 4.7
4:40 PM	55 7		14 4.9
4:55 PM	58 8		14 5.2
5:09 PM	59 9		14 5.4
5:23 PM	62 10		14 5.6
5:37 PM	65 19		14 5.9
5:51 PM	75 11		14 6.1
6:06 PM	78 12		14 6.3
6:20 PM	238	Break	15 6.6
6:35 PM	79 13		14 6.8
6:49 PM	82 14		14 7.1
7:03 PM	90 15		14 7.3
7:17 PM	93 16		14 7.5
7:32 PM	94 17		14 7.8
7:46 PM	97 18		14 8.0
8:00 PM	212	Support/Projects	10 8.2
8:10 PM	220	Support/Projects	10 8.3
8:20 PM	239	Clean up	5 8.4





### **“Custodial Scheduling & Staffing Analysis”:**

We use our scheduling software to address education custodial workflow for both cleaning and service duties beyond cleaning. You will receive assessment analysis to inform your expectations. Fully loaded schedules are developed then followed by refinement.

We offer three different variations of our Custodial Scheduling and Staffing Analysis services. To determine which option best suits your school's needs, please contact us for a personalized consultation.

For more information or to discuss which analysis is right for your schools, please reach out to:

**Mike Stapleton**

mike@smaedu.com

(630) 878-9925